

# Luna Moth Pillows

Lauren + Jessi Jung

Read through the complete pattern instructions before starting.



## DIMENSIONS:

- Finished Pillow Size: 14" x 14"

## SUPPLIES:

- **Moth:** variety of scraps
- **Pillow Fabric:** ½ yard
- **14" Pillow Form**

## PILLOW FRONT

- 1 Cut a 15" x 15" square for pillow background.

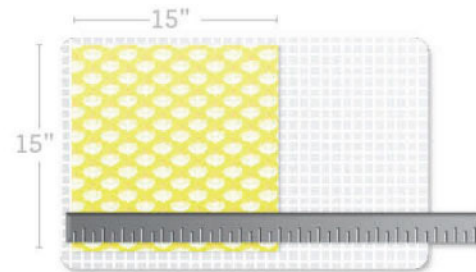

- 2 a/ Fold square in half vertically  
b/ and again horizontally.  
c/ Press folds.

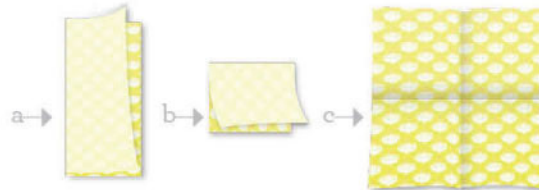

**NOTE:** Fold lines assist in appliqué placement.

- 3 a/ Trace pattern pieces from templates on to dull side of freezer paper. (Be sure to add the identifying letters to each piece.)  
b/ Cut out pieces.

*Hint: Freezer paper is transparent, so lay it on top of the diagram, then trace.*

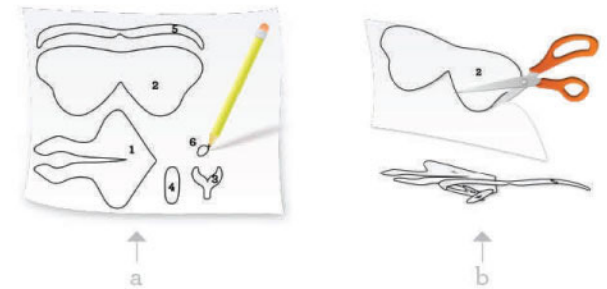

- 4 Press cutout freezer paper pieces, shiny side down, on the right side of your chosen fabric using a dry iron. (Pieces will temporarily stick to fabrics.)



- 5 Trace around pattern pieces on right side of fabric using a mechanical pencil or pen. (Pencil/pen marks will be turned under and hidden when appliquéd.)

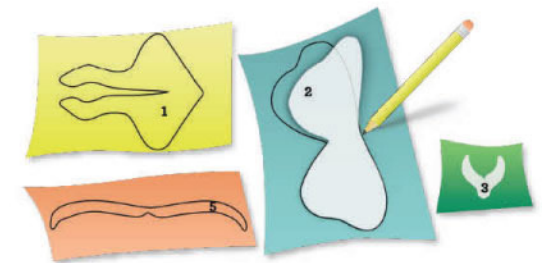

- 6 Cut out drawn fabric pieces leaving a  $\frac{1}{8}$ " edge surrounding each piece.

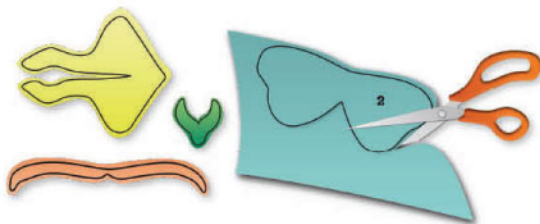

- 7 It is helpful to also trace a complete moth in tact on freezer paper. When layering and pinning moth pieces to background, check the accuracy of your positioning of parts by placing "whole template" on top of fabric pieces.



"whole template" is only used to crosscheck your placement.

- 8 Position and pin pattern pieces on the background square, referring to fold lines and placement chart as guides.



- 9 Use "needle-turn" method of appliqué. Sew moth parts to square in layers following the number sequence on each piece. Do not appliqué edges which will be covered by overlapping layers. (Refer to placement chart.)



## PILLOW CONSTRUCTION

- 10 With right sides together, sew pillow front to pillow back, leaving enough of an opening to squeeze a pillow form through—about 10 inches.



- 11 Turn pillow casing right side out and squeeze pillow form through opening. Hand-stitch the opening closed to complete pillow.



**Lauren+Jessi**  
are excited to introduce their first  
fabric line, Botany!

If you have any questions regarding  
the directions to this pattern, please  
let me know on our blog!  
[www.LaurenAndJessiBlog.com](http://www.LaurenAndJessiBlog.com)

{ LUNA MOTH  
PLACEMENT CHART }

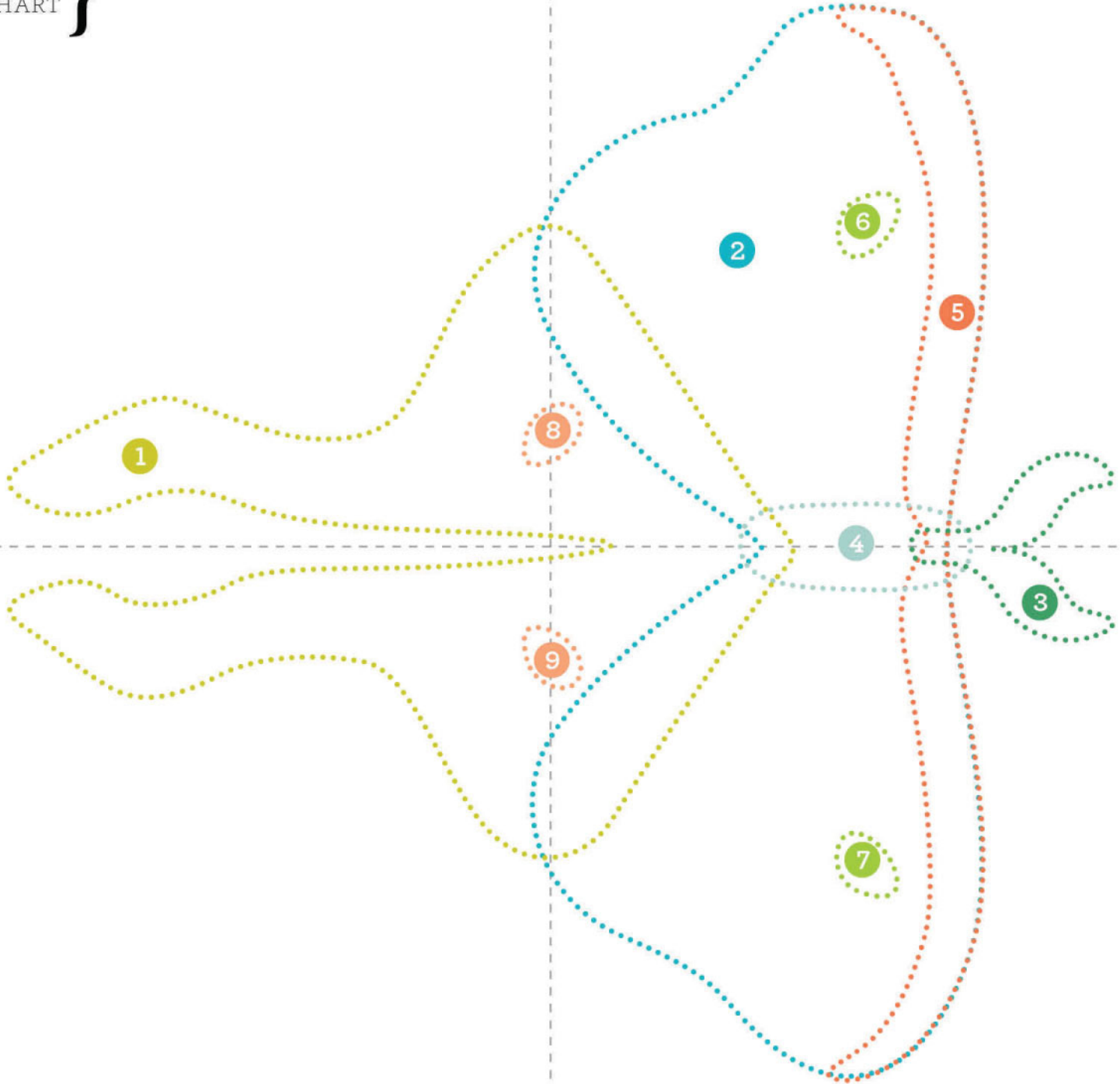

{ LUNA MOTH  
TEMPLATE }

